

CorkSport Adjustable Front Endlinks

2016+ Mazda MX-5



Take your swaybar control to the next level with the CorkSport Adjustable Front Endlinks. These are an absolute must if you want to fine tune your swaybar or have upgraded your swaybar. Give your feedback for the CorkSport Mazdaspeed Car Cover by submitting a review at: <http://corksport.com/mazda-mx5-2016-front-swaybar-end-links.html>

Pre-Installation Notes:



Make sure your vehicle is on a level surface and supported by jack stands (not a hydraulic jack) prior to starting installation. Refer to service manual for lifting and jack stand locations.



These instructions were written for reference only and the use of a factory service manual is recommended. Please read these instructions thoroughly prior to starting installation



These installation instructions were written using a 2016 ND MX-5 Launch Edition. Other models will be similar.



Club Models: The CorkSport Springs are designed to work with OEM Standard and Club models.

Materials and Time:



General Info.

Part #: NDM-3-315-10
Time Est: 30 Minutes
Wrench Rating: 1/5



Tooling List

5mm Allen Wrench
14mm Wrench
16mm Wrench
17mm Wrench



Parts List

1. Two Adjustable Front Endlinks

Need Help With Your Installation?
Call (360) 260-CORK

Order of Operations & Table of Contents



Disassembly

Section 1: OEM Endlinks Removal

Pg. 2



Assembly

Section 2: CorkSport Endlinks Installation

Pg. 2

Detailed Instructions

1. OEM Endlinks Removal

- a) Use a hydraulic jack & jack stands or lift to support the front of the vehicle in the air.
- b) Use a 14mm wrench and 5mm Allen wrench to remove the endlink. **Red circles in Figure 1a.**
- c) Complete for both sides.

2. CorkSport Endlinks Installation

- a) Leave the endlink adjustments loose for installation.
- b) Use a 17mm wrench and 5mm Allen wrench to install the endlink. **Red circles in Figure 2a.**
- c) **Adjusting the endlink length:**
 - a) Use a 14mm wrench to loosen/tighten the jam nuts shown with the blue arrows in Figure 1b.
 - b) Use a 16mm wrench to loosen/tighten the adjustment rod.
 - c) When adjustment is done, tighten the jam nuts against the adjustment rod.
 - d) Note: There is a LH and RH threaded ball joint so you do **NOT** have to remove a ball joint from the vehicle.
- d) Complete for both sides.
- e) **Extension Specs:**
 - a) A **minimum** of 6 threads must be engaged in the extension rod for secure thread interface.



Figure 1a



Figure 2a



Minimum thread engagement

What's Next:

CORKSPORT Adjustable Swaybars

Track tested and racer approved, the CorkSport Front and Rear Swaybars are a great compliment to the daily driver and track rat. Get your body roll under control with the CorkSport 3-Way Adjustable Swaybars.



CorkSport Cold Air Intake System

Reduce intake flow restrictions and maintain cold intake air temperatures with the CorkSport Cold Air Intake. The CorkSport CAI utilized a high flow dry element filter, billet aluminum MAF and custom designed cold air box to give you a clean high flowing intake system. This awesome CorkSport product is still in development; look for it in the near future!

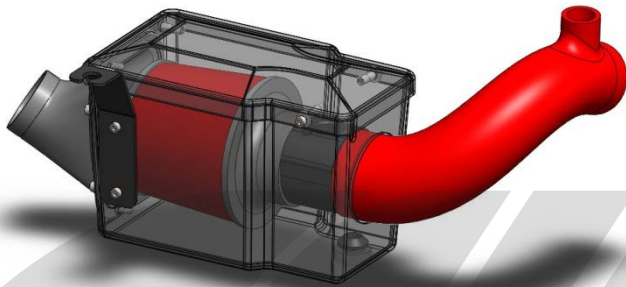

CorkSport Lowering Springs

Track tested and racer approved, the CorkSport Lowering Springs are a perfect match for your daily driven MX-5. The CorkSport Lowering Springs give the MX-5 an aggressive look without sacrificing functionality or ride quality.

