

CorkSport Adjustable Rear Swaybar for 2016+ Miata

2016+ Miata



Thank you for purchasing the CorkSport Adjustable Rear Swaybar. Track tested and racer approved, the CorkSport Rear Swaybar is a great compliment to the daily driver and track rat. Get your body roll under control with the CorkSport 3-Way Adjustable Rear Swaybar.

Please let us know what you think about this box by leaving a review here: <http://corksport.com/mazda-mx5-2016-rear-swaybar.html>

Pre-Installation Notes:



Make sure your vehicle is on a level surface and supported by jack stands (not a hydraulic jack) prior to starting installation. Refer to service manual for lifting and jack stand locations.



These instructions were written for reference only and the use of a factory service manual is recommended. Please read these instructions thoroughly prior to starting installation



These installation instructions were written using a 2016 ND MX-5 Club Edition. Other models will be similar.



Initial Setup Recommendations: Setup the RSB in the softest setting to become familiar with the new driving characteristics of the vehicle. Stiffer settings without an upgraded FSB may cause extreme oversteer.

Materials and Time:



General Info.

Part #: NDM-3-070-10

Time Est: 1 hours

Wrench Rating: 2/5



Tooling List

14mm Wrench

12mm Socket

5mm Allen Wrench

4mm Allen Wrench

Flat Head Screwdriver

Silicone or White

Lithium Grease Spray



Parts List

One (1) Adjustable Rear Swaybar

Two (2) Billet Swaybar Brackets

Two (2) 0.625" Polyurethane
Bushings

Two (2) 0.625" Clamp Collars

One (1) Bushing Lubricant

Need Help With Your Installation?

Call (360) 260-CORK

Order of Operations & Table of Contents



Disassembly

Section 1: OEM RSB Removal

Pg. 2



Assembly

Section 2: CorkSport RSB Installation

Pg. 3-4



Setup:

Section 3: CorkSport RSB Settings

Pg. 5

Detailed Instructions

1. OEM RSB Removal

- a) **Disconnect endlinks from the RSB.** Remove the 14mm nut holding the endlink. If needed, use a 5mm allen wrench to keep the balljoint from rotating. **Red circle in Figure 1a.** Complete this for both sides.

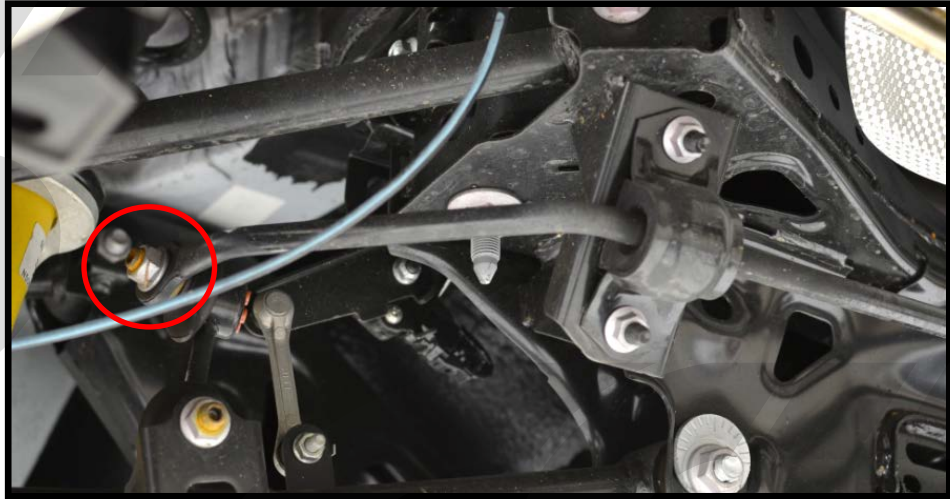

Figure 1a

- b) **Remove the two 12mm nuts holding the swaybar bracket.** **Red circles in Figure 1b.** Complete this for both sides.

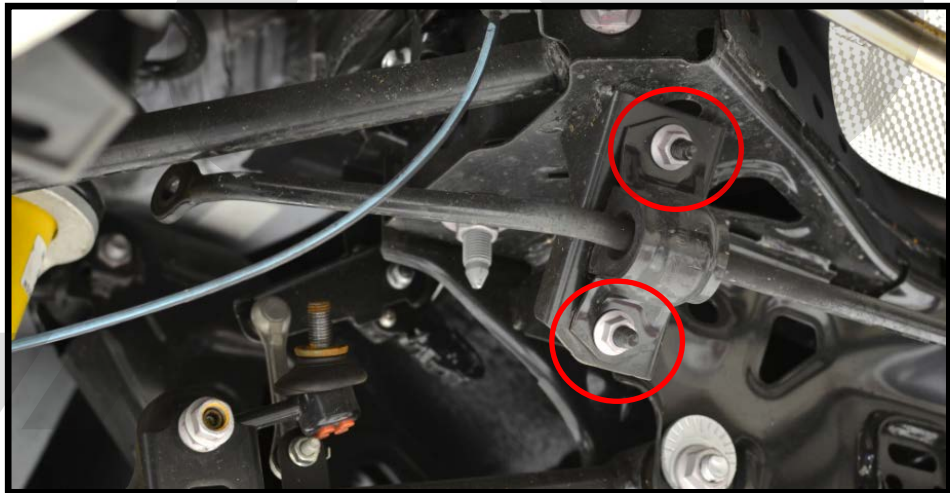

Figure 1b

- c) **Remove the RSB from the vehicle.**

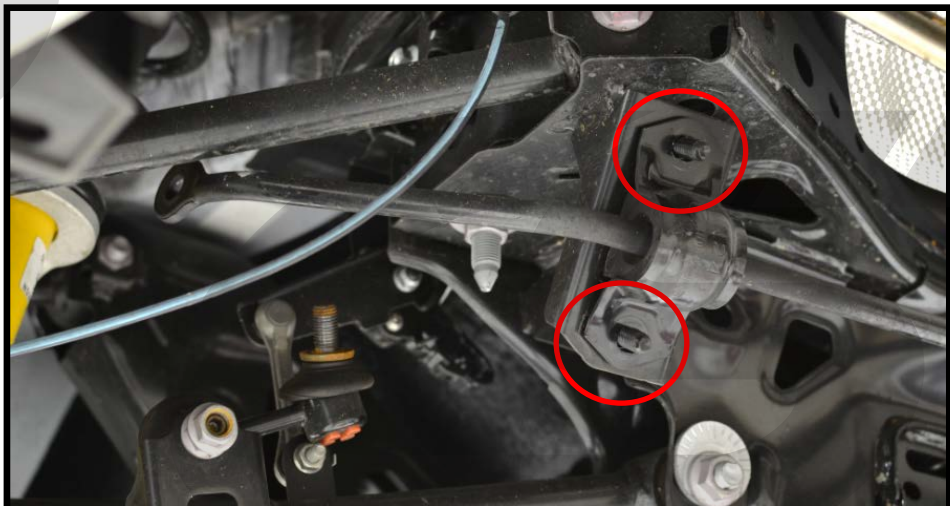

Figure 1c

Part # NDM-3-070

Detailed Instructions

2. CorkSport RSB Installation

- a) **Lubricate the inside of the bushing** with the provided lubricant. Use a large flathead screwdriver to pry the bushing open. Shown in **Figure 2a**.
- b) **With the bushing pried open**, press the bushing onto the RSB. Shown in **Figure 2b**.
- c) **The installed bushing** is shown in **Figure 2c**.
- d) **Lightly lubricate the outside of the bushing for bracket installation**. Use silicone or white lithium grease spray. Shown in **Figure 2d**.



Figure 2a



Figure 2b



Figure 2d



Figure 2c

Need Help With Your Installation?
Call (360) 260-CORK

Detailed Instructions

2. CorkSport RSB Installation (continued)

- a) Press the bracket over the bushing as shown in **Figure 2a**.
- b) Install the assembled RSB onto the vehicle. **Torque the 12mm nuts to 13-19 ft-lbf.**
- c) Install the endlinks onto the RSB. **Torque the 14mm nuts to 32-44 ft-lbf.**
- d) **Center the RSB on the car.** Verify that there is sufficient clearance between the left hand endlink and the headlight position lever. Shown in **Figure 2g**.
- e) Install the clamp collars onto the RSB on the inner side of the bushing as shown in **Figure 2f**. Use a 4mm allen wrench.



Figure 2e

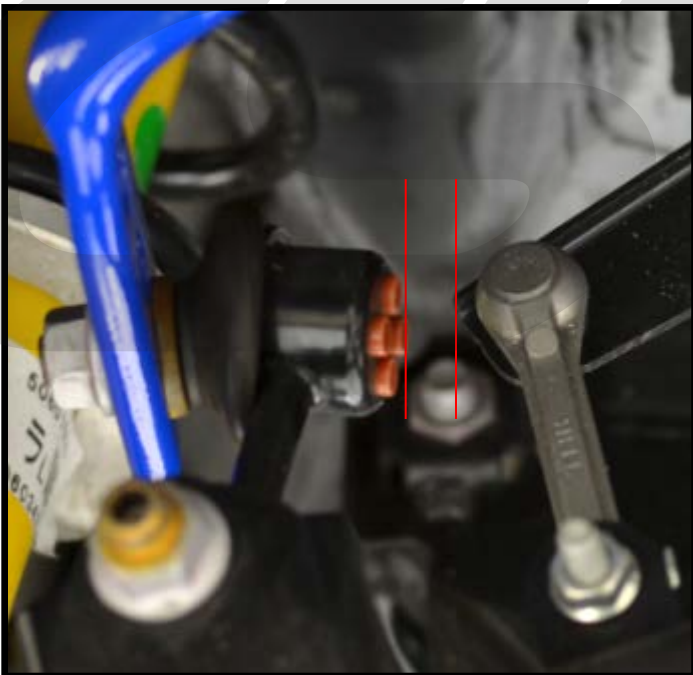

Figure 2g



Figure 2f

Detailed Instructions



This completes the installation of your CorkSport Adjustable Rear Swaybar for 2016+ MX-5. Enjoy the new control and let us know what you think online at CorkSport.com

3. CorkSport RSB Settings

a) The diagram below shows the RSB spring rate percent increase over OEM.

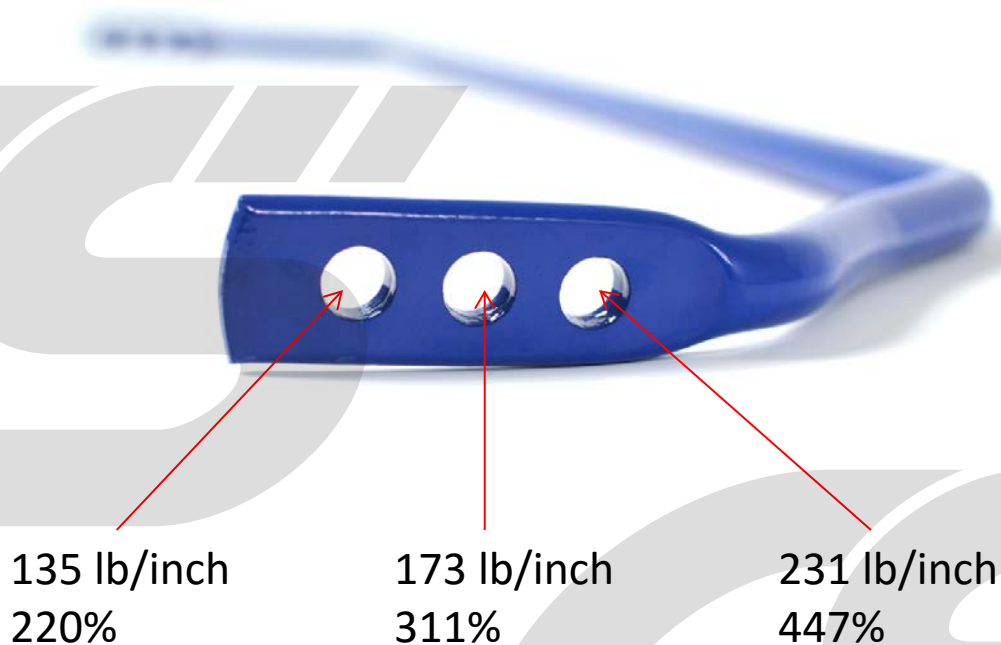

Initial Setup Recommendations: Setup the RSB in the softest setting to become familiar with the new driving characteristics of the vehicle. Stiffer settings without an upgraded FSB may cause extreme oversteer.

What's Next:

CORKSPORT Front Swaybar

Track tested and racer approved, the CorkSport Front Swaybar is a great compliment to the daily driver and track rat. Get your body roll under control with the CorkSport 3-Way Adjustable Front Swaybar.



CorkSport Cold Air Intake System

Reduce intake flow restrictions and maintain cold intake air temperatures with the CorkSport Cold Air Intake. The CorkSport CAI utilized a high flow dry element filter, billet aluminum MAF and custom designed cold air box to give you a clean high flowing intake system. This awesome CorkSport product is still in development; look for it in the near future!

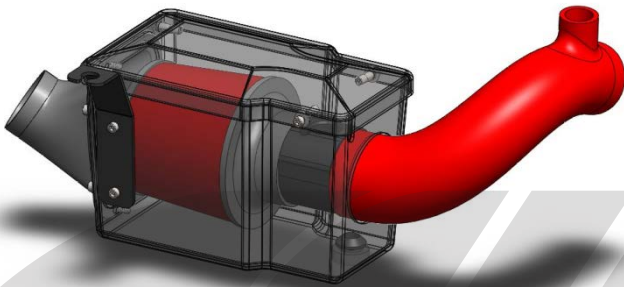

CorkSport Lowering Springs

Track tested and racer approved, the CorkSport Lowering Springs are a perfect match for your daily driven MX-5. The CorkSport Lowering Springs give the MX-5 an aggressive look without sacrificing functionality or ride quality.

