

# CorkSport CX-5 LED Light Kit

2013+ CX-5



Thank you for purchasing the CorkSport Mazda CX5 LED Light Kit. CorkSport's LED light kit replaces the incandescent bulbs for the dome lights, map light, rear hatch, and license plate. The lights simply plug in with no custom adapters or wiring required. We hope you enjoy your new interior lighting. Please let us know your feedback by submitting a review at

<http://www.corksport.com/corksport-mazda-cx5-led-light-kit.html>

## Pre-Installation Notes:



**Make sure your vehicle is completely cooled down** prior to starting installation. If you are going to work on your car within an hour or two of having driven it, use a fan to cool off the car.



**These instructions were written for reference only** and the use of a factory service manual is recommended. Please read these instructions thoroughly prior to starting installation



**How our instructions work:** To best cover all of our customers experience levels, we have included an overview checklist for the more technically advanced users along with step-by-step instructions for customers that require additional detail.



**These installation instructions were written using a 2013+ Mazda CX5.** Other year Mazda CX-5 models will be similar.

## Materials and Time:



### General Info.

Part #: Cx5-9-010  
Time Est: 0.5 hours  
Wrench Rating: 1/5



### Tooling List

Small flat head screwdriver



### Parts List

Five (5) 31mm LED bulb  
Two (2) T10 Wedge LED bulb  
Two (2) 28mm LED bulb

Need Help With Your Installation?

Call (360) 260-CORK

## Checklist

This is an overview of each step in the build. You can use this as a reference and a checklist as you button up the work on your car



*LED bulbs will only work when installed in one direction. Test each bulb in the socket during installation. If it does not work, simply remove it, turn it around, and reinstall it.*



*Be careful when prying the covers off the factory bulb locations. They should come off easily. If they are hard to come off make sure you are prying in the correct orientation.*

### 1. Replacing the Front Overhead Interior Light

- a. Remove the front overhead interior light cover (shown in [Figure 1a](#)).
- b. Pull the bulb out of the socket (circled in [Figure 1b](#)).
- c. Install one of the supplied LED's in the bulbs place (shown in [Figure 1c](#)).
- d. Replace the cover that was removed in step 1a (shown in [Figure 1d](#)).
- e. Repeat steps 1a-1d for the bulb on the other side.

### 2. Replacing the Rear Passenger Overhead Interior Light

- a. Remove the rear passenger overhead light cover (shown in [Figure 2a](#)).
- b. Pull the bulb out of the socket (circled in [Figure 2b](#)).
- c. Install one of the supplied LED's in the bulbs place (shown in [Figure 2c](#)).
- d. Replace the cover that was removed in step 2a.
- e. Repeat steps 2a-2d for the second bulb on the other side.

### 3. Replacing the Trunk and Cargo Area Light

- a. Find the cargo light in the trunk area and remove light cover. It will have a switch on it (pictured in [Figure 3a](#)). Pry the light out starting on the switch side (shown with the [red arrow in Figure 3a](#)).
- b. Pull the bulb out of the socket (circled in [Figure 2b](#)).
- c. Install one of the supplied LED's in the bulbs place.
- d. Replace the cover that was removed in step 3a.

### 4. Replacing the License Plate Lights

- a. Start by locating the license plate bulb covers (shown in [Figure 4a](#)).
- b. Pry the cover off. Start with the clip on the side (shown with a [red arrow in Figure 4a](#)) then the cover should come off easily.
- c. Pull the bulb out by hand (shown in [Figure 4b](#)).

Need Help With Your Installation?

Call (360) 260-CORK

## Checklist

### 4. Replacing the License Plate Lights Continued...

- d. Install one of the supplied round LED's in the bulbs place (shown in **Figure 4d**).
- e. Replace the cover that was removed in step 4a.
- f. Repeat steps 4a-4e for the second license plate light bulb.

### 5. Replacing the Vanity Mirror Lights...



*Sport Models do not have the Vanity lights. All other models will have these lights in the vanity mirrors.*

- a. **Locate the Vanity light in the sun visor.** (Shown in **Figure 5a**) To keep the light from coming on don't open the slide all the way.
- b. **Remove the cover of the light using a small flat head screw driver.** **Figure 5b** shows how the assembly will look once the cover has been removed. Notice the light is off with the slide partially open.
- c. **Replace the factory bulb with the 28mm LED bulb.**
- d. **Repeat Steps 5a-5c for the other vanity light .**



**This completes the installation of your interior LED lighting. Make sure all of the lights are operating properly. If not, make sure all connections and fuses are good and the LEDs are in the proper orientation.**

## What's Next:

[CORKSPORT 2013+ CX-5 SkyActiv Power Series Short Ram Intake](#)



**One of the easiest and most beneficial performance enhancements you can do for your vehicle,** the CorkSport Power Series Short Ram Intake replaces your factory airbox with an open intake system allowing more air into the intake chamber. Engineered with exacting tolerances, the CorkSport SkyActiv Short Ram Intake includes our precision machined MAF housing made from billet aluminum, a durable dry flow air filter and custom reinforced silicone connector. In initial testing with the 2.0 Liter SkyActiv engine, the CorkSport Short Ram Intake netted peak gains of +5 HP and +6 lb torque at the wheels.

## Detailed Instructions

 These instructions are made for a 2013 CX-5

### 1. Replacing the Front Overhead Interior Light

 LED Bulbs will only work when installed in one direction. Test each bulb in the socket during installation. If it does not work, simply remove it, turn it around, and reinstall it.

 Be careful when prying the covers off the factory bulb locations. They should come off easily. If they are hard to come off make sure you are prying in the correct orientation.

a. Start by removing the light cover. Use a small flat head screwdriver to pry the front side of the cover. It will not take much effort. The cover will then come right off (shown in [Figure 1a](#)).

b. Pull the bulb out of the socket (circled in [Figure 1b](#)). If you need to use something to remove the bulb make sure it is non metallic or you may short out a fuse.



Figure 1b

c. Install one of the supplied LED's in the bulbs place, (circled in [Figure 1c](#)). Check to see that it illuminates. If it does not, turn it around and reinstall it.

 Face the LED bulbs straight down for maximum brightness or angle them slightly to diffuse the light a little..

d. Replace the cover that was removed in step 1a. Slide the back of the cover in first and then push the cover into place (shown in [Figure 1d](#)). It will snap into place easily.

e. Repeat steps 1a-1d for the bulb on the other side.



Figure 1a

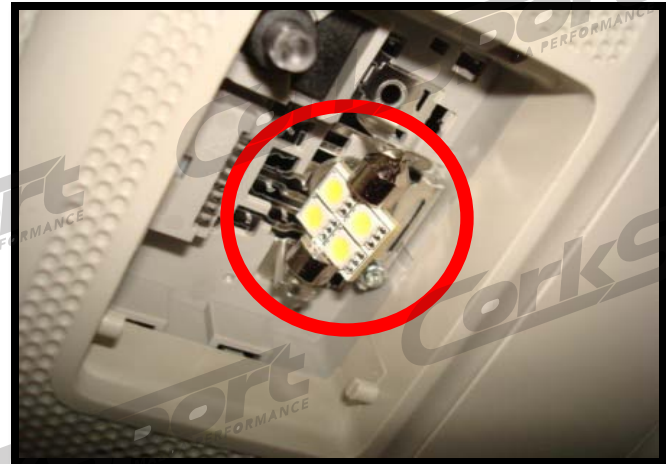

Figure 1c



Figure 1d

## Detailed Instructions

### 2. Replacing the Rear Passenger Overhead Interior Light

- Start by removing the light cover the same way that was recommended on the front overhead interior light in step 1a. Use a small flat head screwdriver to pry the front side of the cover. It will not take much effort. The cover will then come right off (shown in **Figure 2a**).
- Pull the bulb out of the socket (circled in **Figure 2b**). If you need to use something to remove the bulb make sure it is non metallic or you may short out a fuse.



Figure 2a

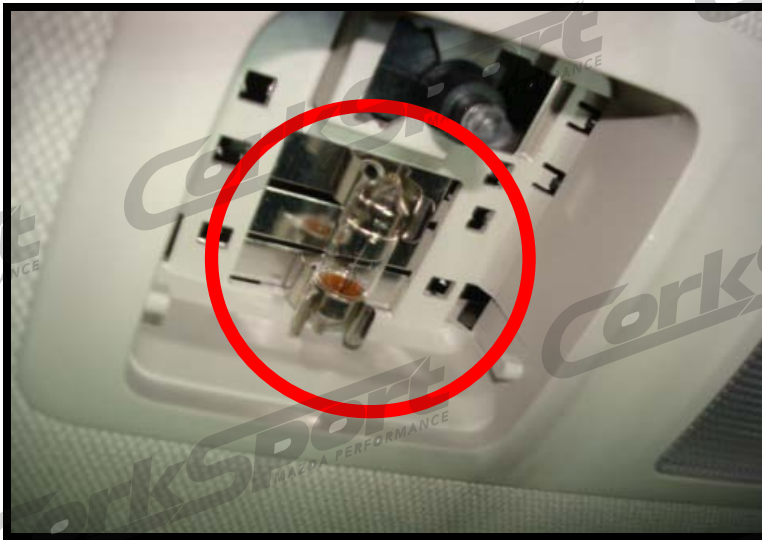



Figure 2b

- Install one of the supplied LED's in the bulbs place (shown in **Figure 2c**). Check to see that it illuminates. If it does not, turn it around and reinstall it.

 Face the LED bulbs straight down for maximum brightness or angle them slightly to diffuse the light a little..

- Replace the cover that was removed in the step 2a. Slide the back of the cover in first and then push the cover into place. It will snap into place easily.
- Repeat steps 2a-2d to replace the bulb on the other side.

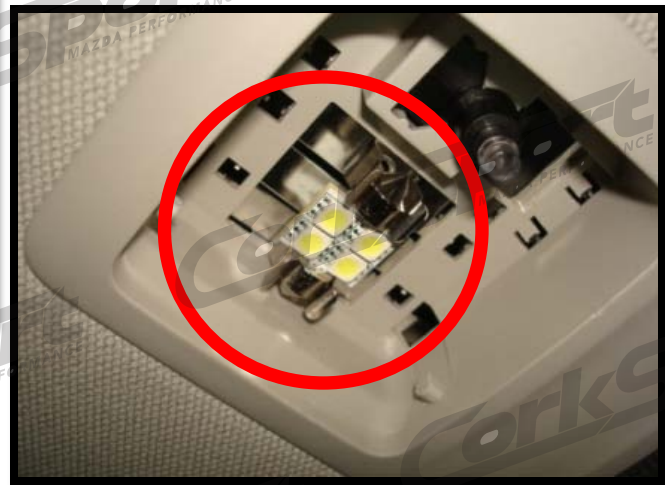

Figure 2c

### 3. Replacing the Trunk and Cargo Area Light

- Start by finding the cargo light in the trunk area. It will have a switch on it (pictured in **Figure 3a**).
- Again with a small flat head, pry the light out starting on the switch side as (shown with the **red arrow** in **Figure 3a**).



Figure 3a

## Detailed Instructions

### 3. Replacing the Trunk and Cargo Area Light (continued)...

- c. Once the light has been removed, pull the bulb out of the socket circled in **Figure 3b**. Again, if you need to use something to remove the bulb make sure it is non metallic or you may short out a fuse.
- d. Again install one of the supplied LEDs in the bulbs place. Check to see that it illuminates. If it does not, turn it around and reinstall it.

 *Face the LED bulbs straight down for maximum brightness or angle them slightly to diffuse the light a little..*

- e. Replace the cover that was removed in step 3a. Slide the non switch side of the cover in first and then push the cover into place. It will snap into place easily.



Figure 3b

### 4. Replacing the License Plate Lights

- a. Start by locating the license plate bulb covers (pictured in **Figure 4a**).
- b. Again with a small flat head, pry the cover off. Start with the clip on the side (shown with a **red arrow** in **Figure 4a**) then the cover should come off easily.
- c. Once the cover is off, pull the bulb out (shown in **Figure 4b**). It should be snug in the socket but it will come out by hand. Once the bulb is removed, the socket should look like **Figure 4c**.



Figure 4a



Figure 4b



Figure 4c

#### 4. Replacing the License Plate Lights (continued)...

- d. Install one of the supplied round LEDs in the bulbs place (shown in **Figure 4d**). Check to see that it illuminates.



**Figure 4d**

- e. Replace the cover that was removed in step 4a. Slide one side in first and then the other will snap into place as you press down.
- f. Repeat steps 41-4e for the second license plate light bulb.

#### 5. Replacing the Vanity Mirror Lights

**!** Sport Models do not have the Vanity lights. All other models will have these lights in the vanity mirrors.

- a. **Locate the Vanity light in the sun visor.** (Shown in **Figure 5a**) To keep the light from coming on don't open the slide all the way.
- b. **Remove the cover of the light using a small flat head screw driver.** **Figure 5b** shows how the assembly will look once the cover has been removed. Notice the light is off with the slide partially open.



**Figure 5a**



**Figure 5b**

Need Help With Your Installation?  
Call (360) 260-CORK

## 5. Replacing the Vanity Mirror Lights Continued...

- c. Replace the factory bulb with the 28mm LED bulb.
- d. Repeat Steps 5a-5c for the other vanity light .



**This completes the installation of your interior LED lighting. Make sure all the lights are operating properly. If not, make sure all connections and fuses are good and the LEDs are in the proper orientation.**

## What's Next:

[CORKSPORT 2013+ CX-5 SkyActiv Power Series Short Ram Intake](#)



**One of the easiest and most beneficial performance enhancements you can do for your vehicle**, the CorkSport Power Series Short Ram Intake replaces your factory airbox with an open intake system allowing more air into the intake chamber. Engineered with exacting tolerances, the CorkSport SkyActiv Short Ram Intake includes our precision machined MAF housing made from billet aluminum, a durable dry flow air filter and custom reinforced silicone connector. In initial testing with the 2.0 Liter SkyActiv engine, the CorkSport Short Ram Intake netted peak gains of +5 HP and +6 lb torque at the wheels.

## [CORKSPORT Underhood LED Light Kit](#)

**Cast a cool white light on your engine bay** with the CorkSport Mazda LED Underhood Lighting Strip. Connected directly to your battery, this easy to install kit uses a pin switch to activate the light when the hood is lifted, giving you and ambient white light that will enhance your Mazda or Mazdaspeed engine bay and keep the area brightly lit for under the hood installations and car shows.

